

HANDLESET

Specifications

Kwikset
UltraMax
Signatures

ULTRAMAX HANDLESET

Door Prep	Deadbolt Cross Bore: 2-1/8" or 1-1/2" Handleset Cross Bore: 2-1/8" Edge Bore: 1" Latch Face: 1" x 2-1/4"
Backset	Deadbolt: Adjustable to 2-3/8" or 2-3/4". Handle: Adjustable to 2-3/8" or 2-3/4".
Door Thickness	1-3/4" doors standard. 2-1/4" doors optional. Not designed for use on 1-3/8" doors.
Cylinder	6-pin. 5-pin optional.
Faceplate	1" x 2-1/4". Specify round corner, square corner or drive-in.
Strikes	Deadbolt: 1-1/4" x 3-5/8". Specify round corner or square corner. Handle: 2-1/4" full lip. Specify round corner or square corner. Other options available.
Bolt	Deadbolt: Brass bolt, Full 1" throw, Titanium alloy roller pin. Handle: 1/2" throw. Nickel plated.
Door Handing	Reversible for right- or left-hand doors. Specify handing when ordering all levers as interior trim for exterior doors.
ADA	N/A
UL	N/A

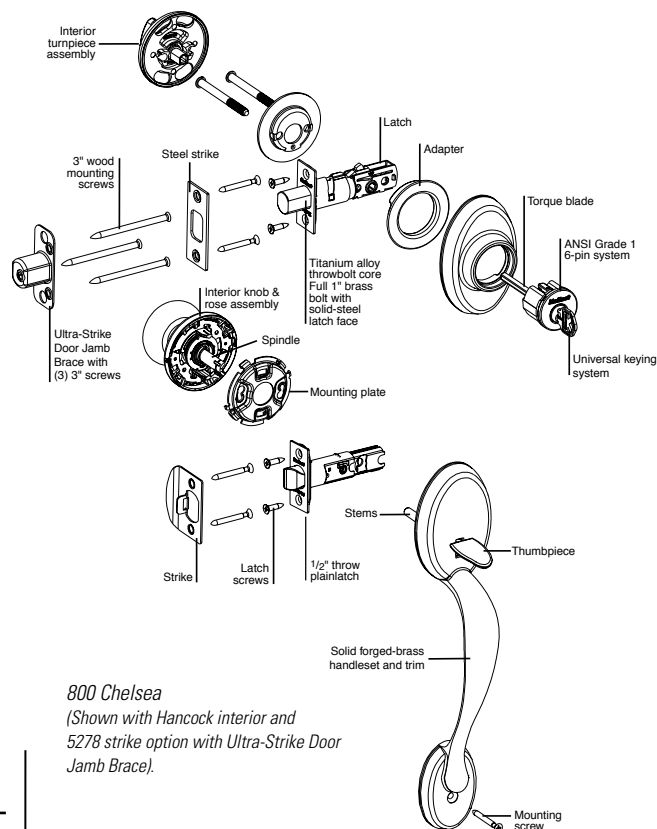

800 Chelsea
(Shown with Hancock interior and
5278 strike option with Ultra-Strike Door
Jamb Brace).

FUNCTIONS

Model 800	801	802
Function Handleset with Single Cylinder Deadbolt	Handleset with Double Cylinder Deadbolt	Dummy Handleset with Dummy Deadbolt
Description Latchbolt operated by thumbpiece outside and grip inside. Deadbolt operated by key outside and thumbturn inside.	Latchbolt operated by thumbpiece outside and grip inside. Deadbolt operated by key both sides.	Handle and grip act as a pull only. For inactive leaf of double doors. No operation.

DIMENSIONS

Design	A	B	C	D
Amherst®	3"	5-1/2"	8-13/32"	18-23/32"
Arlington®	2-17/32"	5-1/2"	11"	19-1/16"
Chelsea®	2-5/32"	5-1/2"	9-11/16"	18-1/2"
Hawthorne®	2-7/8"	5-1/2"	8-13/32"	17-9/16"
Shelburne®	2-7/8"	5-1/2"	8-13/32"	18-1/4"
Sheridan®	2-3/4"	5-1/2"	11"	18-9/16"
Wellington®	2-7/8"	5-1/2"	8-13/32"	18-15/16"

OPTIONS

Description	See Page	Note
Split Finishes		Price is higher of two finishes.
Keying	58	Keyed Alike (KA) is standard.
2 1/4" thick door screw pack	60-61	
Faceplates		Included. Specify round corner, square corner or drive-in.
Strikes	51-52	Included. Specify round corner, square corner or full round.
Latches	47-50	Adjustable to 2 3/8" or 2 3/4". Specify round corner, square corner or drive-in.
Cylinder core & housing	54-55	